



Engineering
Approved

**MODEL 47J
 MAINTENANCE AND OVERHAUL INSTRUCTIONS
 TEMPORARY REVISION 47-15-1**

REFERENCE: Alert Service Bulletin 47-15-27

REASON: To improve integrity check of the throttle linkage assembly and graphically clarify proper safety wire installation of the throttle linkage assembly.

SAFETY WIRING OF THROTTLE CONTROL LINKAGE ASSEMBLY

Revise the Maintenance and Overhaul Instructions as follows and record this Temporary Revision on the "RECORD OF ACTIVE TEMPORARY REVISIONS" page:

- Add the "RECORD OF ACTIVE TEMPORARY REVISIONS" (page TR, which is included on the last page of this Temporary Revision) immediately prior to the "LIST OF EFFECTIVE PAGES" (page A) in the M&O manual. Review the M&O manual and the SB47 website for any other active Temporary Revisions and record them on this "RECORD OF ACTIVE TEMPORARY REVISIONS" page.
- Section I, Daily Inspection, Page 1-50, Rev 0, 1 November 1965
 POWER PLANT AND ENGINE COMPARTMENT
 Revise Step 8 to address throttle linkage-carburetor security check:
 - 8. Inspect throttle, mixture, carburetor heat and fuel shut-off controls for general condition and security. Check controls for freedom of operation and full operating range. Check the throttle linkage-carburetor attachment for condition and security and for the presence and correct installation of the safety wire.
- Section III, Page 3-17, Rev 0, 1 November 1965
 Revise Figure 3-11 as shown on page 2 of this Temporary Revision:

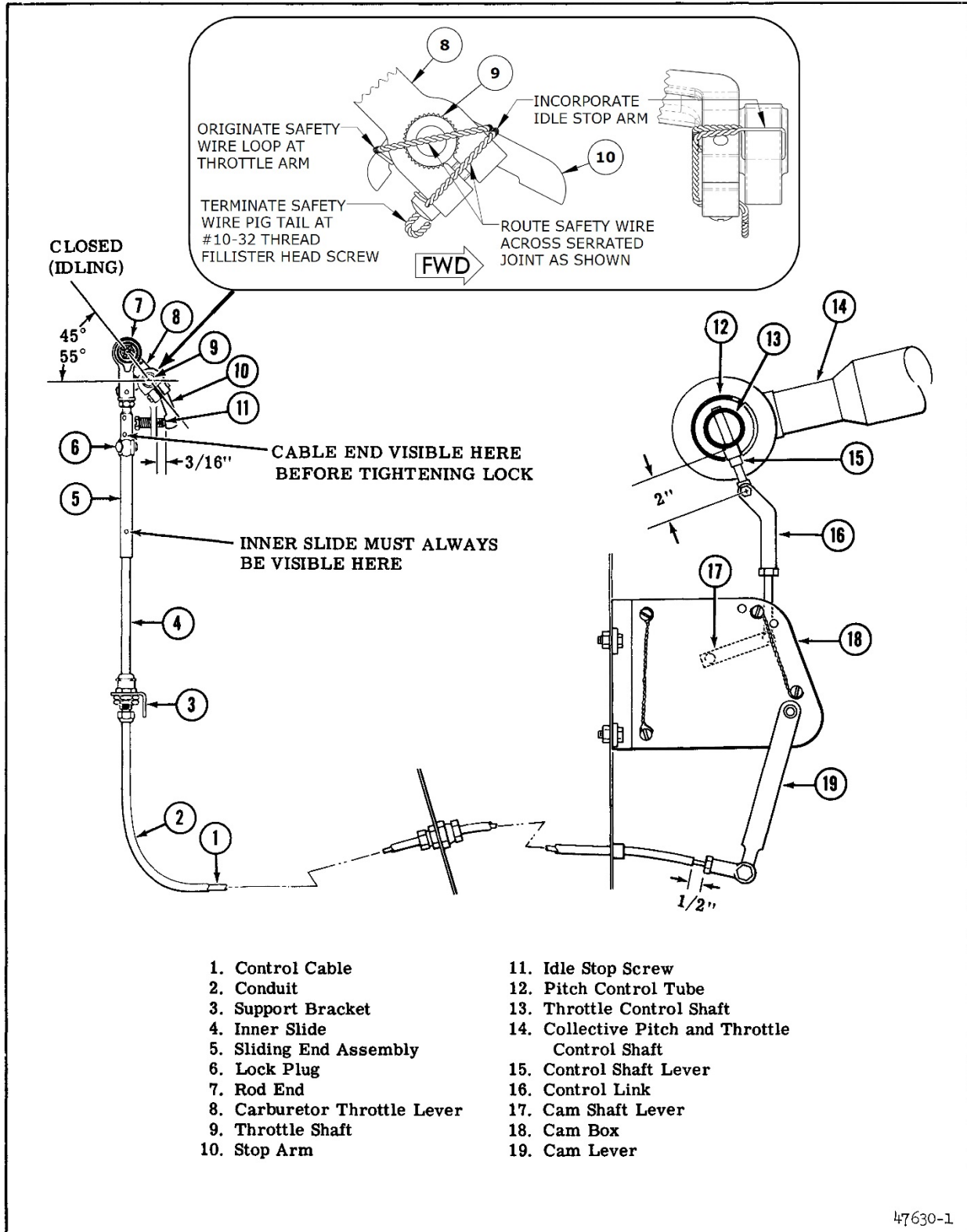

47630-1

Figure 3-11. Throttle Linkage Adjustment

**MAINTENANCE & OVERHAUL
INSTRUCTIONS**

RECORD OF ACTIVE TEMPORARY REVISIONS

Revision Number	Chapter/Page Number	Issue Date	Date Inserted	By	Date Removed	By